

EMERGENCY INFORMATION

PROCEED TO ASSEMBLY AREA
by the safest route

The area supervisor will account for all persons in their area and then report to the Emergency Controller.

Remain in your allocated Assembly Area until further instructed by your supervisor.



EMERGENCY EVACUATION PROCEDURE

If circumstances permit

Turn off equipment

Close all windows

Leave all lights ON

Close all doors but **DO NOT** lock

For **EMERGENCY** or **FIRST AID** assistance
phone 222 or 49802222

LEGEND	
ADM	Administration
T	Turner Wing
MH	Media / Laurels
W	White Building
LIB	Library
CC	College Church
WH	Watson Hall
EB	Ella Boyd/Andre
CAF	Cafeteria / Pool
CSA	Auditorium
OR	Outdoor Rec.
BH	Bethel
MB	Music
C	College Hall
GH	Greer Hall
BS	Business Studies
E	Education Building
CH	Chemistry
NU	Nursing
X	Garden Shed
Y	Maintenance
LC	Ladies Chapel

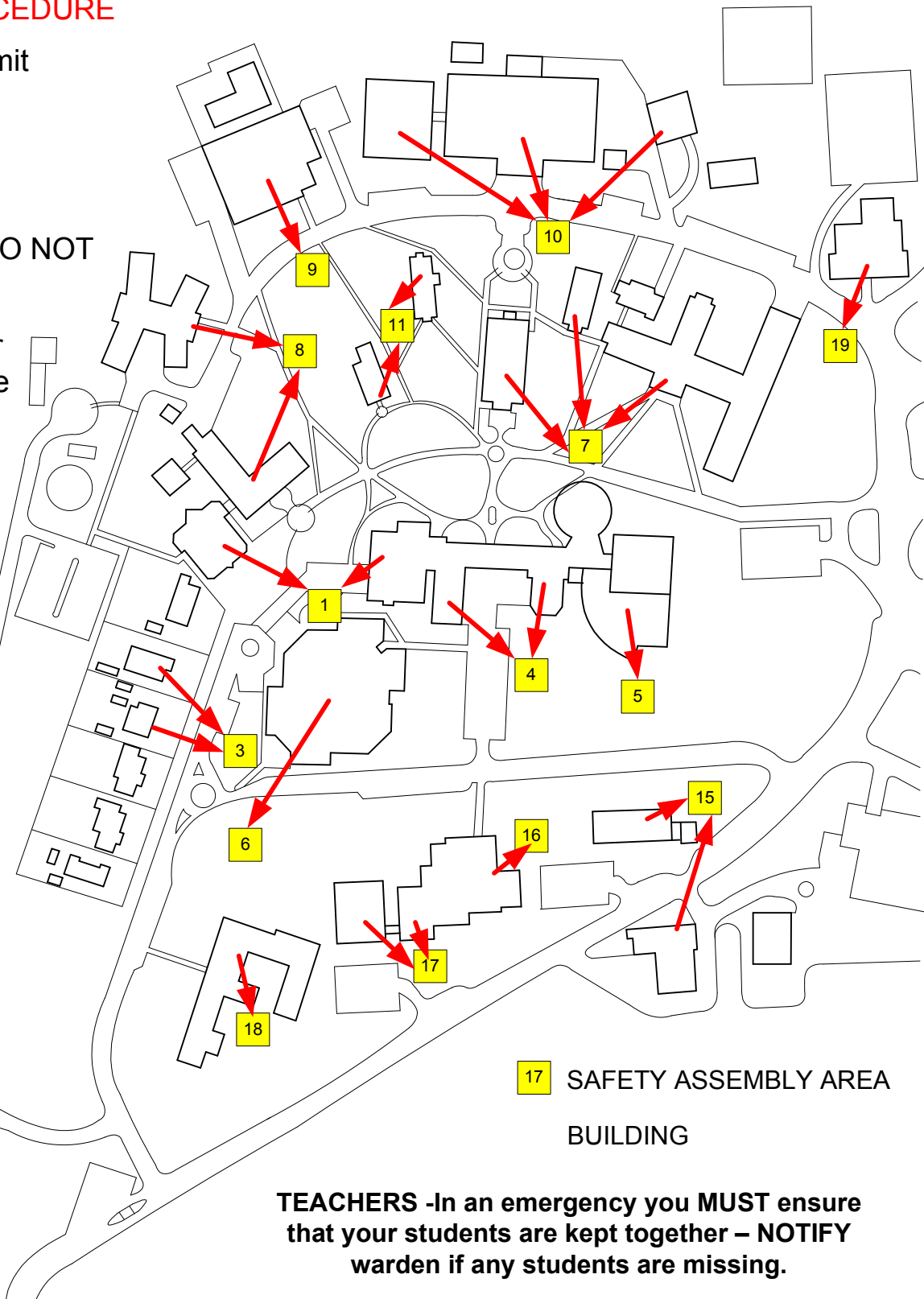

TEACHERS -In an emergency you MUST ensure that your students are kept together – NOTIFY warden if any students are missing.